

## EQUIPMENT DATA SHEET - 500te Climbing Jack

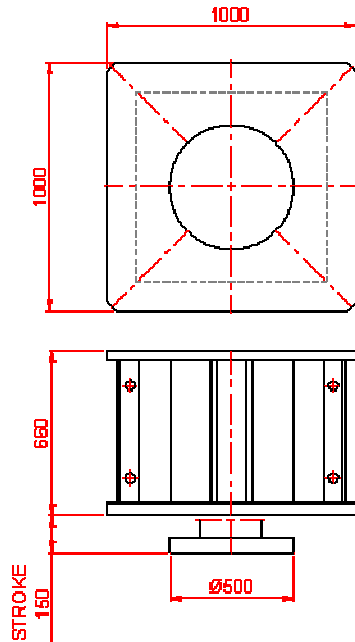

### 500te Climbing Jack

<b>Equipment Number</b>	01041-01
<b>Capacity</b>	500te @ 400 bar
<b>Dimensions</b>	1000x1000x660
<b>Weight</b>	1908 kg
<b>Material</b>	S235

The 500te Climbing Jack is the largest capacity jack in the climbing jack series. At maximum capacity 9 timbers per layer are required. Please contact ALE for further information on allowable jacking heights and stability.



Step 1: extend jack and raise load



Step 2: Insert timbers on the sides



Step 3: retract piston and insert timbers



Step 4: extend jack and raise load

For reference only

