

EQUIPMENT DATA SHEET – BOLSTER SET – 3000t (1500t / BOLSTER)

For the transport of particularly long vessels or modules where maneuverability on the route is essential, ALE have a range of bolsters to meet this requirement.

The 3000 series bolsters system allow the load to be supported on two turntables which offer the operators greater flexibility to negotiate obstacles on the route such as sharp corners, roundabouts, etc.

Compared to conventional bolster, the 3000 series ALE bolster has one free oscillating ball in front and another oscillating ball with two slippers at the rear. The free oscillating ball makes the load distribution in the trailers and the column statically determinate. This bolster system is designed specifically **not to overload the saddles** and maintain stability especially on uneven surfaces.

Conventional bolsters without the free oscillating ball and slippers relies on the transverse stability of the trailer hydraulics which creates load stresses onto the saddles which can lead to critical failure of the saddles.

Two slippers are installed to the front of ALE bolster but with clearances, these are to protect the column from tipping. Stability is maintained using the hydraulic suspension of the trailers which support the cargo via the slippers on the bolster positioned either side of the ball joint.

The cargo can either be bolted to the top of the bolster or cleated to a sacrificial plate which is supplied by ALE.

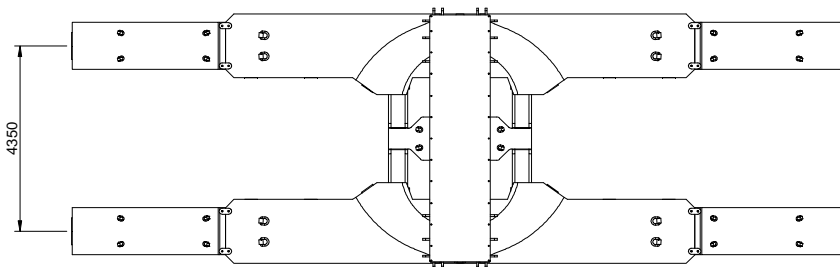
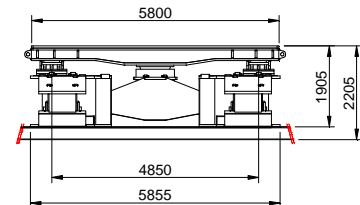
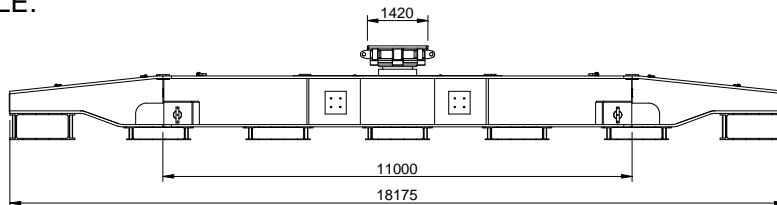
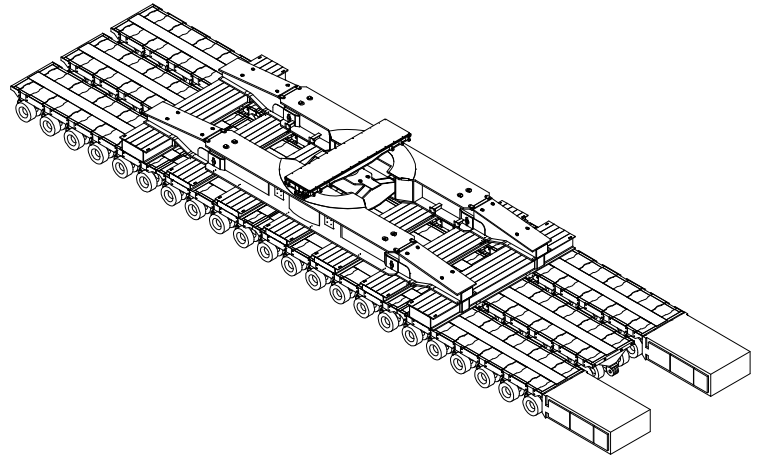

3000t BOLSTER SPECIFICATION
(Fixed bolster shown)
Capacity: 1500 tonnes per bolster
Weight (excl. loadspreading):
approx. 100 tonnes

